

ADMINISTRATIVE AMENDMENT (PD) ADD2005-00011

ADMINISTRATIVE AMENDMENT  
LEE COUNTY, FLORIDA

WHEREAS, Touchstone Homes at Rapallo filed an application for administrative approval to a Mixed Use Planned Development on a project known as Rapallo for reducing the size of the required 118 square feet to 71 square feet for a waste container pad on property located as part of Coconut Point DRI, described more particularly as:

LEGAL DESCRIPTION: In Section 04, Township 47 South, Range 25 East, Lee County, Florida:

See Exhibit "A"

WHEREAS, the property was originally rezoned in case number DCI2001-00005(with subsequent amendments in case numbers ADD2004-00048 and DOS2004-00053); and

WHEREAS, the Lee County Land Development Code provides for certain administrative changes to planned development master concept plans and planned unit development final development plans; and

WHEREAS, ADD2004-00048 approved relief from LDC Section 10-261 which requires multiple family buildings to provide dumpsters for all units with attached garages; and

WHEREAS, the request was granted to replace the dumpster with a waste container pad adjacent to the right of way; and

WHEREAS, conditions were set as to the size required and are outlined in condition 4 of ADD2004-00048; and

WHEREAS, the applicant has asked the county to review the size requirements for waste container pads; and

WHEREAS, this applicant seeks approval for reducing the size of the required 118 square feet for a waste container pad to 71 square feet (5.5' X 13.0') to service four units, which share a common; and

WHEREAS, the proposed reduced size has been verified and approved by Lee County Solid Waste Division as stated in Exhibit "B" from William Newman; and

WHEREAS, the lesser dimensions will not impact negatively on the general appearance and landscaping requirements as previously approved; and

WHEREAS, the subject application and plans have been reviewed by the Lee County Department of Community Development in accordance with applicable regulations for compliance with all terms of the administrative approval procedures; and

WHEREAS, it is found that the proposed amendment does not increase density or intensity within the development; does not decrease buffers or open space required by the LDC; does not underutilize public resources or infrastructure; does not reduce total open space, buffering, landscaping or preservation areas; and does not otherwise adversely impact on surrounding land uses.

NOW, THEREFORE, IT IS HEREBY DETERMINED that the application for administrative approval for an amendment to Mixed Use Planned Development is **APPROVED**.

**Approval is subject to the following conditions:**

1. **The Development must be in compliance with the amended Master Concept Plan, dated January 2005 and stamped received by the permit counter on January 19, 2005. Master Concept Plan for ADD2005-00011 is hereby APPROVED and adopted. A reduced copy is attached hereto.**
2. **The terms and conditions of the original zoning resolutions remain in full force and effect.**

DULY SIGNED this 17<sup>th</sup> day of March, A.D., 2005.

BY: \_\_\_\_\_

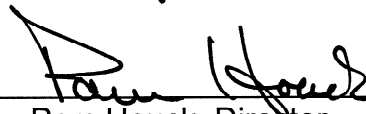

Pam Houck, Director  
Division of Zoning  
Department of Community Development

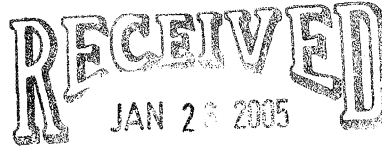

PERMIT COUNTER

LEGAL DESCRIPTION

A PORTION OF SECTION 9, TOWNSHIP 47 SOUTH, RANGE 25 EAST, LEE COUNTY, FLORIDA, BEING MORE PARTICULARLY DESCRIBED AS FOLLOWS:

COMMENCE AT THE SOUTHEAST CORNER OF SECTION 9, TOWNSHIP 47 SOUTH, RANGE 25 EAST, LEE COUNTY, FLORIDA; THENCE RUN S.88°56'17"W., ALONG THE SOUTH LINE OF THE SOUTHEAST QUARTER OF SAID SECTION 9, FOR A DISTANCE OF 5.89 FEET TO A POINT ON THE WESTERLY RIGHT-OF-WAY LINE OF THE SEABOARD COASTLINE RAILROAD, A 130.00 FOOT RIGHT-OF-WAY, AND THE POINT OF BEGINNING OF THE PARCEL OF LAND HEREIN DESCRIBED; THENCE CONTINUE S.88°56'17"W., ALONG THE SOUTH LINE OF THE SOUTHEAST QUARTER OF SAID SECTION 9, FOR A DISTANCE OF 1,733.04 FEET TO A POINT ON THE EASTERLY RIGHT-OF-WAY LINE OF U.S. HWY. NO. 41 (FLORIDA STATE ROAD NO. 45), A 200.00 FOOT RIGHT-OF-WAY; THENCE RUN N.10°32'05"W., ALONG SAID EASTERLY RIGHT-OF-WAY LINE, FOR A DISTANCE OF 971.33 FEET TO THE BEGINNING OF A TANGENTIAL CIRCULAR CURVE, CONCAVE EASTERLY; THENCE RUN NORTHERLY, ALONG SAID EASTERLY RIGHT-OF-WAY LINE AND ALONG THE ARC OF SAID CURVE TO THE RIGHT, HAVING A RADIUS OF 5,605.39 FEET, THROUGH A CENTRAL ANGLE OF 04°03'11", SUBTENDED BY A CHORD OF 396.43 FEET AT A BEARING OF N.08°30'30"W., FOR A DISTANCE OF 396.52 FEET TO THE END OF SAID CURVE; THENCE RUN N.88°07'51"E. FOR A DISTANCE OF 747.22 FEET TO A POINT ON A CIRCULAR CURVE, CONCAVE EASTERLY, WHOSE RADIUS POINT BEARS N.82°31'42"E., A DISTANCE OF 3,909.60 FEET THEREFROM; THENCE RUN NORTHERLY, ALONG THE ARC OF SAID CURVE TO THE RIGHT, HAVING A RADIUS OF 3,909.60 FEET, THROUGH A CENTRAL ANGLE OF 08°29'31", SUBTENDED BY A CHORD OF 578.92 FEET AT A BEARING OF N.03°13'32"W., FOR A DISTANCE OF 579.45 FEET TO THE END OF SAID CURVE; THENCE RUN N.00°15'56"W., FOR A DISTANCE OF 583.09 FEET; THENCE RUN N.00°15'56"W., FOR A DISTANCE OF 47.04 FEET TO A POINT ON THE SOUTHERLY RIGHT-OF-WAY LINE OF COCONUT ROAD, A 150.00 FOOT RIGHT-OF-WAY, THE SAME BEING A POINT ON A CIRCULAR CURVE, CONCAVE NORTHERLY, WHOSE RADIUS POINT BEARS N.10°26'58"W., A DISTANCE OF 2,025.00 FEET THEREFROM; THENCE RUN EASTERLY, ALONG SAID SOUTHERLY RIGHT-OF-WAY LINE AND ALONG THE ARC OF SAID CURVE TO THE LEFT, HAVING A RADIUS OF 2,025.00 FEET, THROUGH A CENTRAL ANGLE OF 09°12'27", SUBTENDED BY A CHORD OF 325.07 FEET AT A BEARING OF N.74°56'48"E., FOR A DISTANCE OF 325.42 FEET TO THE END OF SAID CURVE; THENCE RUN N.70°20'35"E., ALONG SAID SOUTHERLY RIGHT-OF-WAY LINE FOR A DISTANCE OF 200.00 FEET TO THE BEGINNING OF A TANGENTIAL CIRCULAR CURVE, CONCAVE SOUTHERLY; THENCE RUN EASTERLY, ALONG SAID SOUTHERLY RIGHT-OF-WAY LINE AND ALONG THE ARC OF SAID CURVE TO THE RIGHT, HAVING A RADIUS OF 3,025.00 FEET, THROUGH A CENTRAL ANGLE OF 09°15'04", SUBTENDED BY A CHORD OF 487.89 FEET AT A BEARING OF N.74°58'07"E., FOR A DISTANCE OF 488.42 FEET TO THE END OF SAID CURVE; THENCE RUN N.79°35'39"E., ALONG SAID SOUTHERLY RIGHT-OF-WAY LINE, FOR A DISTANCE OF 238.23 FEET TO A POINT ON THE WESTERLY RIGHT-OF-WAY LINE OF THE SEABOARD COASTLINE RAILROAD, A 130.00 FOOT RIGHT-OF-WAY; THENCE RUN S.00°59'47"E., ALONG SAID WESTERLY RIGHT-OF-WAY LINE, FOR A DISTANCE OF 2,869.10 FEET TO THE POINT OF BEGINNING; CONTAINING 95.885 ACRES, MORE OR LESS.

AND

A PORTION OF SECTIONS 3, 4, 9, AND 10, TOWNSHIP 47 SOUTH, RANGE 25 EAST, LEE COUNTY, FLORIDA, BEING MORE PARTICULARLY DESCRIBED AS FOLLOWS:

COMMENCE AT THE SOUTHEAST CORNER OF SECTION 9, TOWNSHIP 47 SOUTH, RANGE 25 EAST, LEE COUNTY, FLORIDA; THENCE RUN S.88°56'17"W., ALONG THE SOUTH LINE OF THE SOUTHEAST QUARTER OF SAID SECTION 9, FOR A DISTANCE OF 5.89 FEET TO A POINT ON THE WESTERLY RIGHT-OF-WAY LINE OF THE SEABOARD COASTLINE RAILROAD, A 130.00 FOOT RIGHT-OF-WAY; THENCE RUN N.00°59'47"W., ALONG SAID WESTERLY RIGHT-OF-WAY LINE, FOR A DISTANCE OF 3,021.15 FEET TO THE POINT OF BEGINNING OF THE PARCEL OF LAND HEREIN DESCRIBED; THENCE RUN N.00°59'47"W., ALONG SAID WESTERLY RIGHT-OF-WAY LINE, FOR A DISTANCE OF 2,320.56 FEET TO A POINT ON THE NORTH LINE OF THE NORTHWEST QUARTER OF SECTION 10, TOWNSHIP 47 SOUTH, RANGE 25 EAST; THENCE RUN N.00°59'47"W., ALONG SAID WESTERLY RIGHT-OF-WAY LINE, FOR A DISTANCE OF 2,692.32 FEET TO A POINT ON THE NORTH LINE OF THE SOUTHEAST QUARTER OF SECTION 4, TOWNSHIP 47 SOUTH, RANGE 25 EAST; THENCE RUN

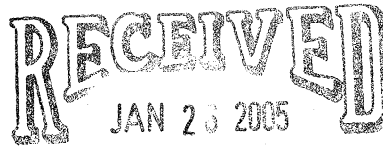

HM PROJECT #1995085

1/17/01

REF. DWG. #A-994-3

PAGE 2 OF 23

PERMIT COUNTER

N.00°56'59"W., ALONG SAID WESTERLY RIGHT-OF-WAY LINE, FOR A DISTANCE OF 1,590.78 FEET TO THE BEGINNING OF A TANGENTIAL CIRCULAR CURVE, CONCAVE WESTERLY; THENCE RUN NORTHERLY, ALONG SAID WESTERLY RIGHT-OF-WAY LINE AND ALONG THE ARC OF SAID CURVE TO THE LEFT, HAVING A RADIUS OF 5,641.38 FEET, THROUGH A CENTRAL ANGLE OF 09°31'27", SUBTENDED BY A CHORD OF 936.68 FEET AT A BEARING OF N.05°42'42"W., FOR A DISTANCE OF 937.76 FEET TO THE END OF SAID CURVE; THENCE RUN N.10°28'26"W., ALONG SAID WESTERLY RIGHT-OF-WAY LINE, FOR A DISTANCE OF 98.54 FEET TO A POINT ON THE SOUTHERLY RIGHT-OF-WAY LINE OF WILLIAMS ROAD, A 100.00 FOOT RIGHT-OF-WAY; THENCE RUN S.88°20'53"W., ALONG SAID SOUTHERLY RIGHT-OF-WAY LINE, FOR A DISTANCE OF 1,029.70 FEET TO THE BEGINNING OF A TANGENTIAL CIRCULAR CURVE, CONCAVE NORTHERLY; THENCE RUN WESTERLY, ALONG SAID SOUTHERLY RIGHT-OF-WAY LINE AND ALONG THE ARC OF SAID CURVE TO THE RIGHT, HAVING A RADIUS OF 7,050.00 FEET, THROUGH A CENTRAL ANGLE OF 03°00'00", SUBTENDED BY A CHORD OF 369.09 FEET AT A BEARING OF S.89°50'53"W., FOR A DISTANCE OF 369.14 FEET TO THE END OF SAID CURVE; THENCE RUN N.88°39'07"W., ALONG SAID SOUTHERLY RIGHT-OF-WAY LINE, FOR A DISTANCE OF 674.92 FEET TO A POINT ON THE EASTERLY RIGHT-OF-WAY LINE OF U.S. HWY. NO. 41 (FLORIDA STATE ROAD NO. 45), A 200.00 FOOT RIGHT-OF-WAY; THENCE RUN S.04°52'41"W., ALONG SAID EASTERLY RIGHT-OF-WAY LINE, FOR A DISTANCE OF 1,901.57 FEET TO THE BEGINNING OF A TANGENTIAL CIRCULAR CURVE, CONCAVE EASTERLY; THENCE RUN SOUTHERLY, ALONG SAID EASTERLY RIGHT-OF-WAY LINE AND ALONG THE ARC OF SAID CURVE TO THE LEFT, HAVING A RADIUS OF 2,725.19 FEET, THROUGH A CENTRAL ANGLE OF 11°32'50", SUBTENDED BY A CHORD OF 548.30 FEET AT A BEARING OF S.00°53'44"E., FOR A DISTANCE OF 549.23 FEET TO THE END OF SAID CURVE; THENCE RUN S.06°40'09"E., ALONG SAID EASTERLY RIGHT-OF-WAY LINE FOR A DISTANCE OF 225.81 FEET TO A POINT ON THE NORTH LINE OF THE SOUTHEAST QUARTER OF SAID SECTION 4; THENCE CONTINUE S.06°40'09"E., ALONG SAID EASTERLY RIGHT-OF-WAY LINE, FOR A DISTANCE OF 2,710.61 FEET TO A POINT ON THE SOUTH LINE OF THE SOUTHEAST QUARTER OF SAID SECTION 4; THENCE CONTINUE S.06°40'09"E., ALONG SAID EASTERLY RIGHT-OF-WAY LINE, FOR A DISTANCE OF 626.03 FEET TO THE BEGINNING OF A TANGENTIAL CIRCULAR CURVE, CONCAVE WESTERLY; THENCE RUN SOUTHERLY, ALONG SAID EASTERLY RIGHT-OF-WAY LINE AND ALONG THE ARC OF SAID CURVE TO THE RIGHT, HAVING A RADIUS OF 11,584.73 FEET, THROUGH A CENTRAL ANGLE OF 06°24'13", SUBTENDED BY A CHORD OF 1,294.08 FEET AT A BEARING OF S.03°28'03"E., FOR A DISTANCE OF 1,294.76 FEET TO THE END OF SAID CURVE; THENCE RUN S.00°15'56"E., ALONG SAID EASTERLY RIGHT-OF-WAY LINE, FOR A DISTANCE OF 274.74 FEET; THENCE RUN S.46°02'16"E., FOR A DISTANCE OF 577.44 FEET; THENCE RUN S.01°57'26"E. FOR A DISTANCE OF 25.19 FEET TO A POINT ON THE NORTHERLY RIGHT-OF-WAY LINE OF COCONUT ROAD, A 150.00 FOOT RIGHT-OF-WAY; THENCE RUN N.88°02'34"E., ALONG SAID NORTHERLY RIGHT-OF-WAY LINE, FOR A DISTANCE OF 32.80 FEET TO THE BEGINNING OF A TANGENTIAL CIRCULAR CURVE, CONCAVE NORTHERLY; THENCE RUN EASTERLY, ALONG SAID NORTHERLY RIGHT-OF-WAY LINE AND ALONG THE ARC OF SAID CURVE TO THE LEFT, HAVING A RADIUS OF 1,875.00 FEET, THROUGH A CENTRAL ANGLE OF 17°41'59", SUBTENDED BY A CHORD OF 576.92 FEET AT A BEARING OF N.79°11'34"E., FOR A DISTANCE OF 579.22 FEET TO THE END OF SAID CURVE; THENCE RUN N.70°20'35"E., ALONG SAID NORTHERLY RIGHT-OF-WAY LINE, FOR A DISTANCE OF 200.00 FEET TO THE BEGINNING OF A TANGENTIAL CIRCULAR CURVE, CONCAVE SOUTHERLY; THENCE RUN EASTERLY, ALONG SAID NORTHERLY RIGHT-OF-WAY LINE AND ALONG THE ARC OF SAID CURVE TO THE RIGHT, HAVING A RADIUS OF 3,175.00 FEET, THROUGH A CENTRAL ANGLE OF 09°15'04", SUBTENDED BY A CHORD OF 512.09 FEET AT A BEARING OF N.74°58'07"E., FOR A DISTANCE OF 512.65 FEET TO THE END OF SAID CURVE; THENCE RUN N.79°35'39"E., ALONG SAID NORTHERLY RIGHT-OF-WAY LINE, FOR A DISTANCE OF 263.08 FEET TO THE POINT OF BEGINNING; CONTAINING 386.536 ACRES, MORE OR LESS.

## NOTES:

THIS PROPERTY IS SUBJECT TO EASEMENTS, RESERVATIONS OR RESTRICTIONS OF RECORD.

TOTAL PROPERTY AREA: 482.421 ACRES, MORE OR LESS.

INFORMATION RELATING TO BOUNDARY DATA OF SECTIONS 3, 4, 9 AND 10, TOWNSHIP 47 SOUTH, RANGE 25 EAST, LEE COUNTY, FLORIDA, TOGETHER WITH THE LOCATION OF THE US HIGHWAY #41 RIGHT-OF-WAY, WAS OBTAINED FROM A SURVEY OF THE SWEETWATER RANCH PREPARED BY DENI ASSOCIATES HAVING ORDER NUMBER 8409031, DATED 9/14/84. INFORMATION RELATING TO THE LOCATION OF COCONUT ROAD

HM PROJECT #1995085

1/17/01

REF. DWG. #A-994-3

PAGE 3 OF **23**

AND ADJOINING EXCEPTED PARCELS WAS OBTAINED FROM PROPERTY DESCRIPTIONS PROVIDED BY CLIENT.

BEARINGS REFER TO THE SOUTH LINE OF THE SOUTHEAST QUARTER OF SECTION 9, TOWNSHIP 47 SOUTH, RANGE 25 EAST, LEE COUNTY, FLORIDA, AS BEING S.88°56'17"W.

HOLE, MONTES, INC.

CERTIFICATE OF AUTHORIZATION LB #1772

BY 

JERRY D. RIFFELMACHER

P.S.M. #6130

STATE OF FLORIDA

**RECEIVED**  
JAN 28 2005

PERMIT COUNTER

Applicant's Legal Checked

by  27 JAN 05

ADD 2005 00011

**RECEIVED**  
JAN 25 2005

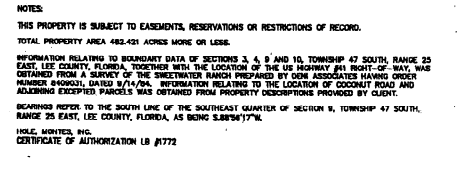

Applicant's Legal Checked  
by AM 27JAN05





CURVE TABLE					
CURVE	RADIUS	LENGTH	CHORD	BEARING	DELTA
C1	2622.00	320.42	323.07	N75°56'48"E	87°12'27"
C3	3028.00	488.42	487.88	N75°56'47"E	87°10'45"
C5	7050.00	368.14	367.08	S80°50'53"W	3°00'00"
C4	2725.18	548.23	548.30	S00°53'44"E	11°32'50"
C6	11584.73	1284.76	1284.68	S02°28'03"E	8°24'13"
C7	18776.00	979.32	978.82	N72°11'24"E	17°41'58"
C8	31726.00	812.85	812.78	N64°58'07"E	8°56'54"

""NOT A SURVEY""



**HOLE MONTES**  
ENGINEERS-PLANNERS-SURVEYORS

DRAWING NO.	A-994-3
PROJECT NO.	19970798
REFERENCE NO.	SWEETREV3

FIELD BOOK		
		
		
		
		
LETTER	REVISIONS	DATE

**DATE: March 2 , 2005**

**FROM: Shawn Lamey**  
**Planner, Zoning**

**The above referenced project is asking to reduce the required 118 SF waste container pad to 71 SF. Do you object to this request?**

Shawn  
715 SF will be ok for the 4 unit buildings,  
however 1055 SF is as low as I will allow  
for the 6 unit buildings.

Five sq. ft. per unit is Required for Recycling and I am allowing for two garbage cans per unit at 30" diameter each.

Recycling 6 units  $\times$  5 SF = 30 SF  
Garage 6 units  $\times$  2 cars  $\times$  (25)<sup>2</sup> = 75 SF  
 105 SF

**cc: Zoning File**

RECEIVED  
MAR 10 2005

## COMMUNITY DEVELOPMENT

JAN 19 2005

PERMIT COUNTER

ADD2005-00011

36

35

5.5'  
13'  
6'

LANDSCAPE BUFFER

WASTE CONTAINER PAD (TYP.):

REQUIRED 118 SF PER COMMON DRIVEWAY  
(PER ADD2004-00048(4))

REQUESTED 71 SF PER COMMON DRIVEWAY  
W/ 3' WIDE x 3' HIGH LANDSCAPE BUFFER  
ON SIDES NOT ADJACENT TO ROADWAY

VIA RAPALLO

34

**APPROVED**

Amended Plan

Subject to Case #ADD2005-00011

Date 3-18-05

PROJECT: RAPALLO - WASTE CONTAINER PADS

CLIENT: TOUCHSTONE HOMES AT RAPALLO

**WilsonMiller**

Planners • Engineers • Ecologists • Surveyors • Landscape Architects • Transportation Consultants

WilsonMiller, Inc.

Naples • Fort Myers • Sarasota • Bradenton • Tampa • Tallahassee  
4571 Colonial Boulevard, Suite 100 • Fort Myers, Florida 33912 • Phone 239-939-1020 • Fax 239-939-7479 • Web-Site www.wilsonmiller.com

WilsonMiller, Inc. - FL Lic# LC 000070  
WilsonMiller, Inc. - Certificate of Authorization #43

SCALE: 1" = 30'		DATE: JANUARY 2005	
SEC: 4	TWP: 47S	RGE: 25E	REV NO:
PROJECT NO: 04198-002-000		INDEX NO: A-4198-01	
DRWN BY/EMP NO: C.A.S./1686		SHEET NO: 2 OF 2	